

Uniclass L6813	
CI/SfB	Ln6 (L34)

November 2011

The original damp-proofing membrane system

# PLASTER-LATH<sup>®</sup> Easy-to-use Damp-proof system for walls

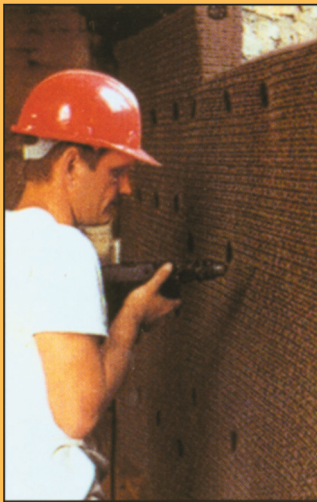

## Fixing

Fixing is by the special polypropylene Plaster-Lath plug at 250mm centres. An area 100mm free of mesh on the Plaster-Lath allows firm and positive overlap jointing.



## Dry lining

Dry lining can be fixed to Plaster-Lath by applying adhesive plaster dabs directly onto Plaster-Lath fixings. (See manufacturer's instructions for full guide).

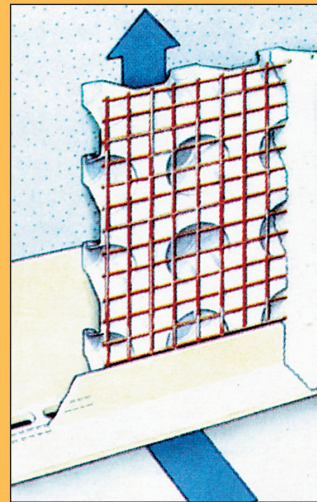

## Ventilation

The air gap can be vented externally via an air vent or internally using the PT-profile strips at the top and bottom of the system.



## Rendering

Plaster-Lath will accept traditional renders and plaster. All applications are applied in two coats. (See fixing instructions for full guide).

- Damp-proof system for walls
- Provides key for plaster, render or dab fix
- Fast-track application
- Controls damp; salts & contaminated surfaces
- Air gap improves insulation
- Easy to use, easy to handle, just drill & fix

**Basement**  
INFORMATION CENTRE

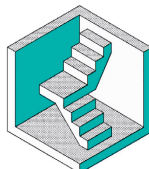

Certificate EN ISO 9001



# The fast-track damp-proof system guaranteed for 30 years

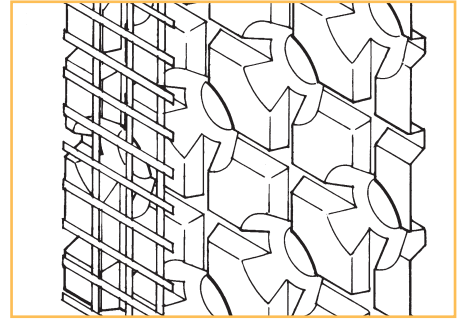

## PLASTER-LATH®

The 'Original' damp-proof plastic membrane systems which eliminates dampness, the effects of salts and contaminated backgrounds. Guaranteed for 30 years.

The surface of the membrane has a meshed key permanently manufactured to it, which provides a key for render, plaster, or dab fixing plasterboard.

The dimpled design creates an air gap, which insulates and allows for ventilation, and natural drying of the wall, while providing a dry decorative finish internally.

The air gap can be vented externally via an air vent or internally using the PT-profile strips at the top and bottom of the system.

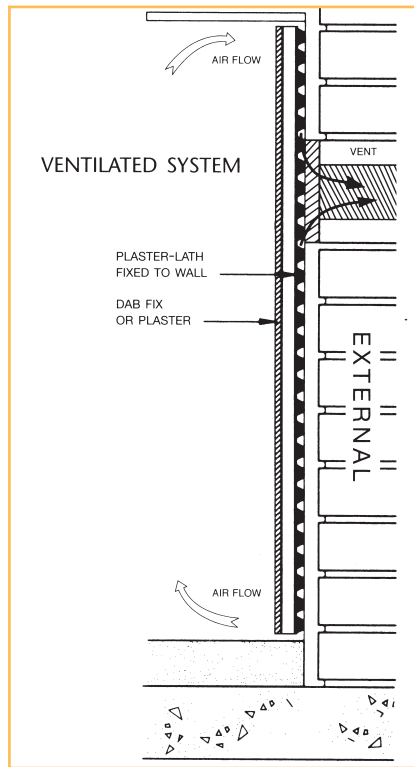
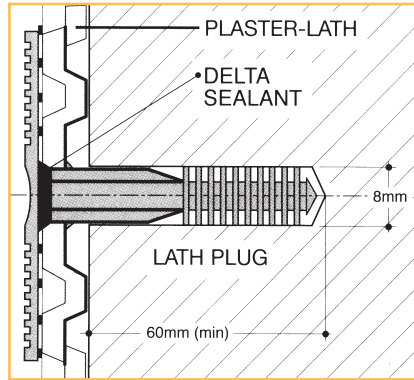

### Technical Data

SIZE	supplied in rolls 1.5m x 10m (15m <sup>2</sup> )
WEIGHT	8.5kg per roll
DEPTH	< 8mm
RESISTANCE TO COMPRESSION	80kN/m <sup>2</sup>
TENSILE STRENGTH	600N/60mm
ELASTICITY	60% (approx)
TEMPERATURE RESISTANCE	Thermal resistance for 105mm outer leaf at 2.7% v/V moisture content is: $0.105 = 0.072\text{mm}^2\text{K/W}$ 1.485
STANDARD U-VALUES	Plaster-Lath+ plaster+105mm brick wall 2.25W/m <sup>2</sup> K Plaster-Lath+ Plaster+220mm brick wall 1.72W/m <sup>2</sup> K
HEALTH & SAFETY	No health hazard

### Specification guide

JOINTING	Plaster-Lath to be lap jointed either horizontally or vertically allowing 100mm overlap.
FIXING	At 250mm internally and 150mm externally (maximum) Vertical and horizontal centres by Plaster-Lath Plugs, following manufacturer's instructions.
PLASTERING*	In accordance with BS5492
RENDERING*	In accordance with BS5262
DECORATION	Renderings to be thoroughly dry before Painting or application of wallpapers etc.

\* Refer to manufacturer's instructions for specific plasters and renders.

### Guarantee

Plaster-Lath is guaranteed against deterioration for a period of 30 years on condition that it has been fixed and finished in accordance with the manufacturer's instructions. Delta MS Ltd cannot be held responsible for the performance of plasters, renders or other finishes.

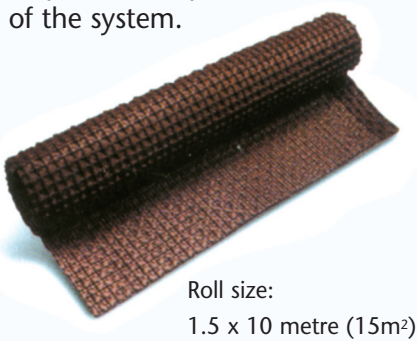

Available from:

**DELTA Membrane Systems Ltd**  
Delta House, Merlin Way, North Weald, Epping, Essex CM16 6HR  
tel: 01992 523523 fax: 01992 523250  
email: info@deltamembranes.com Website: www.deltamembranes.com